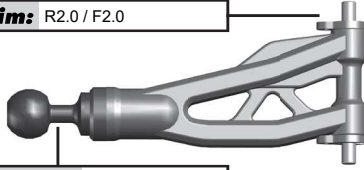
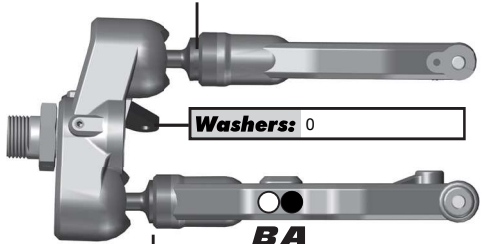

Front Suspension:
RESET

Ride Height: 26mm
Camber: -1
Toe: 0
Anti-Roll Bar
Size: Noir (2.4mm)
Gap:
Ackerman
Notes:
Drive Shaft: CVAs: <input type="checkbox"/> Universals: <input checked="" type="checkbox"/>
Chassis Brace: Short: <input type="checkbox"/> Long: <input checked="" type="checkbox"/>
Hex:
Notes:

Caster Shim: R2.0 / F2.0

Upper Ball Type: Aluminium

Upper Ball Shim: 0

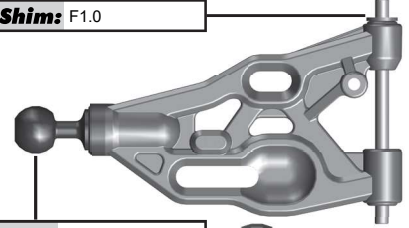
Washers: 0

BA
Lower Ball Shim: 0

Wheelbase Shim: F1.0

Lower Ball Type: Aluminium

Upper Arm Mount:
Arm Mount A:
Arm Mount B:

Rear Suspension:

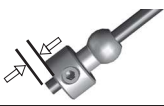
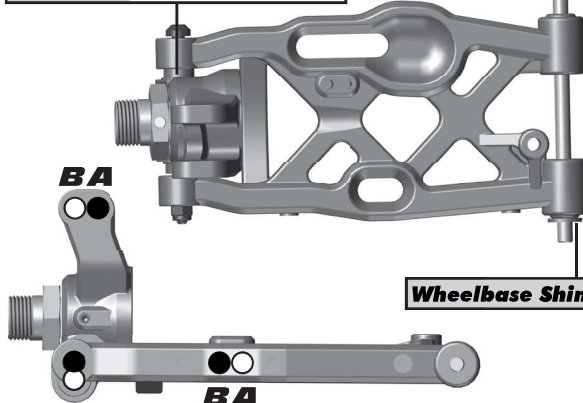
Ride Height: 28mm
Camber: -1
Anti-Roll Bar
Size: Gris (2.7mm)
Gap:
Drive Shaft: CVAs: <input type="checkbox"/> Universals: <input checked="" type="checkbox"/>
Chassis Brace: Short: <input type="checkbox"/> Long: <input checked="" type="checkbox"/>
Hex:
Notes:

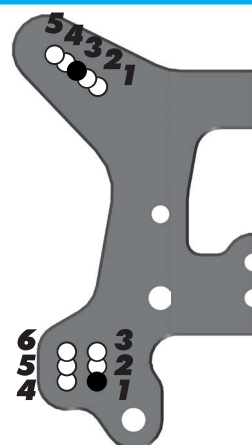
Hub Shim: centre

BA
Wheelbase Shim: R2.0

Arm Mount C:
Arm Mount D:

Electronics:

Radio: Futaba 4PX
Servo: Hitec SH-7954SH
EPA: Throttle: 100 % Brake: 40 %
EXPO: Throttle: -15 % Brake: -30 %
ESC: Mamba Monster X
Motor: Castle 1515 2200Kv (sensored)
Battery: Dynamite HV 6500mAh
Notes: Steering: Exp -35 / EPA 94%

Differential Fluid:

Front: 5000
Center: 7000
Rear: 3000
Notes:

Shocks:

	Front	Rear
Piston:	6x1.3	6x1.3
Fluid:	35wt	30wt
Cap:	Bleed	Bleed
Rebound:	25%	25%
Spring:	Bleu	Bleu
Free Length:	100mm	120mm
Notes:		

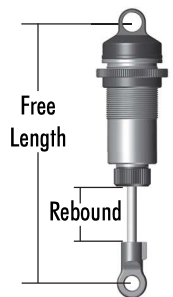
Gearings:

Spur Gear: 46
Pinion: 12
Notes:

Track Info:

Size: Small <input type="checkbox"/> Medium <input checked="" type="checkbox"/> Large <input type="checkbox"/> Extra Large <input type="checkbox"/>
Surface: Dirt <input checked="" type="checkbox"/> Carpet <input type="checkbox"/> Astroturf <input type="checkbox"/> Multi Surface <input type="checkbox"/>
Traction: Low <input type="checkbox"/> Medium <input checked="" type="checkbox"/> High <input checked="" type="checkbox"/> Very High <input type="checkbox"/>
Moisture: Dry <input type="checkbox"/> Damp <input checked="" type="checkbox"/> Wet <input type="checkbox"/>
Condition: Indoor <input type="checkbox"/> Outdoor <input checked="" type="checkbox"/> Dusty <input type="checkbox"/> Hard Packed <input checked="" type="checkbox"/>
Bumpy <input type="checkbox"/> Grooved <input type="checkbox"/> Smooth <input type="checkbox"/> Loamy <input type="checkbox"/>
Temperature: Ambient: 25°C Track:
Notes:

Tires:

Front Tires: Aka Gridron II
Front Compound: Soft
Front Insert: stock
Rear Tires: Aka Gridron II
Rear Compound: Soft
Rear Insert: stock
Wheel (F/R): Aka
Notes: Terre humide = CityBlock Soft

Body, Wings:

Body: Stock
Wing: JConcepts High Down Force
Wing Height: High: <input type="checkbox"/> Low: <input checked="" type="checkbox"/>
Gap to Tower: 17mm
Weight:
Total Vehicle Weight:
Notes:

Vehicle Comments:
Notes: www.lemordudurc.com